

WE210



BASE ENGINE POWER	129 kw - 173 hp
OPERATING WEIGHT	19800 - 21900 kg



BUILT AROUND YOU

WE210

NEW HOLLAND STAGE IIIA ENGINE

- Powerful with high torque at lower speed
- High productivity with lower pollution

HIGH PERFORMANCE HYDRAULIC SYSTEM

- 3-pumps hydraulic system
- Dedicated pump for full independent swing operation
- Simultaneous movements under every load
- Autopowerboost: maximum power available where needed





HIGH STABILITY EVERSATILE

- Outstanding lifting capacities and operating stability
- Up to 12 storable attachments in pressure and flow
- New proportional controls for blade/stabilisers and rotating clamshell/tilting bucket circuit

SPACIOUS AND COMFORTABLE CAB

- All-around visibility, parallelogram windshield wiper
- Standard air-suspension seat and tilting left console
- New joysticks with ergonomic handle

EASY MAINTENANCE AND SERVICEABILITY

- Ground level access to engine filters and radiators
- Safe service platform to access engine compartment

WE210 THE POWER OF



RESPECTING THE ENVIRONMENT

The NewHolland wheeled excavators are compliant with European Directives concerning electromagnetic compatibility and noise level. The emissions of the Stage IIIA NewHolland engines have been dramatically reduced and are, as shown below, much lower than standard requirements.

WE210 = CO: 0.77, HC: 0.08, NOX: 3.59, PARTICULATE: 0.13 (*)

In addition, this engine can use normal diesel, with up to 20% of Biodiesel added...

...a real Environmentally Friendly machine.

(*) all data are expressed in g/kWh

CONTROL



NEW HOLLAND ENGINE

The NewHolland, 6 cylinders, 6.7 litres mechanical engine develops a power of 129 kW at 2000 rpm and a torque of 745 Nm at lower rpm... **an extremely flexible and responsive power plant.**

A larger displacement engine guarantees:

- Higher torque for higher productivity
- Longer lifespan
- Higher reliability

The available **FINE/ECO/POWER modes**, linked to engine speed, facilitates the operator which could find always the best according to the job to do.

A variable speed **hydrostatic fan**, automatically actuated by a thermostatic sensor, draws fresh and clean air from outside through the radiators optimizing both cooling effect and noise level.

SUPERIOR TRACTION

The heavy duty axles are combined with a powershift transmission -mounted on rear one for a better protection and high ground clearance- to provide **outstanding power train system** resulting into a perfect match of high traction performances and smoothness in gear shifting.

The transmission can be operated in both manual and automatic mode.

With manual mode the operator can either select the 1st or the 2nd gear, while in "full automatic mode" the transmission will autoshift up or down simplifying travelling both on field and road.

Pressing the accelerator pedal, the **Travel Mode** is automatically activated assuring to the power train system the full availability of engine power.

HEAVY DUTY AXLE

NewHolland wheeled excavators are equipped with robust axles proven for any **heavy duty** applications contributing into high machine reliability.

The **patented disc brake** design works directly on the axles hubs eliminating the annoying backlash effect, typical of while working free on wheels.



WE210 ADVANCED VERS

EFFICIENCY AND CONTROLLABILITY

To obtain a Hydraulic System which is efficient, controllable, fast and powerful, and which consumes low fuel, New Holland has been working on every hydraulic component with a 360° approach:

- **state-of-the-art pumps** supply high flow, are prompt to react to all requirements and extremely noiseless;
- **refined control valve** and **new generation joysticks** give precise and total machine control;
- **electronic Pump Control System mark IV** continuously optimizes hydraulic output according to operator and job demands, providing the best machine controllability, productivity, operator comfort and fuel saving.
- **Automatic PowerBoost** and **Levelling Mode** allow to work without problems in every application with maximum productivity and controllability

The new low effort joysticks feature a longer stroke properly transferred into proportional and smooth control of all machine movements... a **real, effective Control of Power** allowing longer work times with less fatigue.



VERSATILITY

Auxiliary circuits are available, as option, for:

- Low flow clamshell rotation circuit, 22 l/min with ON/OFF control
- Medium flow clamshell rotation/tilting bucket circuit, 80 l/min with proportional control
- High flow/high pressure hammer/shears circuit, with proportional control

The proportional control for rotating clamshell or tilting bucket operation is now **operated by a slider** on top of the left joystick, while the foot pedal is maintained for the high flow circuit: this combination assures the full control of all possible tools.

By the monitor, it is possible to adjust pressure and flow to match the operating parameters of the attachment being used.

In addition up to 12 combinations of pressure and flow can be memorized for future use.



NEW JOYSTICK

The new ergonomic design of handles provides **comfortable and safe grip** giving the feeling of total and superior machine control.

On the right joystick, there is the **innovative control** for blade and stabilisers: a slider operating up/down provides a **full independent and proportional control** keeping always the hand on joystick for maximum operator safety.

By the switches on the left console, **blade and stabilisers** can be activated for simultaneous or independent operation.

SABILITY



HIGH STABILITY

The whole structures of **WE210** have been designed to guarantee a perfect match with their high performances, by improving position of centre of gravity, by optimising stresses distribution and by adopting high quality steel plates. To eliminate bumps and shocks to the whole structure when the pistons reach their stroke end, cylinders have been equipped with automatic recovery and cushioning systems.

The wider axles to reach an undercarriage width of 2.75 m are available as option on WE210, effectively contributing to increased stability; the wider axles can have some restrictions when travelling on road according to local authorities and laws.

All this adds up to guarantee an excellent and safe machine with dynamic stability when working in any kind of job and on all types of ground.

This excellent stability enhances **outstanding lifting capacity**, which can be fully exploited, thanks to the weight strategically distributed in its structure, without unpleasant jumping effects.

OBJECT HANDLING KIT

European Standards state rules of thumb that do not allow free interpretation to each European Country. In case of object handling operations, an excavator can be used **only if certified by manufacturer** that it is equipped with all safety devices required by European Standards EN 474-5:1996. New Holland, confirming its commitment to grant high performances in an extremely safe environment, offers its customers the **optional Object Handling Kit** for maximum operator confidence.



WE210 OPERATOR SAFE



SPACIOUS CAB

Roomy cab on New Holland wheeled excavators offers to the operator an outstanding place where to work.

All around visibility, safety and ergonomics are its main features to maximise operator comfort and to enable optimum performance.

The integrated ROPS contributes to a safe and rigid construction of cab, which is mounted on rubber mounts, assuring to the operator minimum vibrations while working and a protective environment in the unlucky event of a roll-over.

The standard FOPS marks a milestone for the operator safety which New Holland devotes its care.

Threaded holes, integrated into the cab structure, enable fast and easy mounting of optional front guard, **effectively contributing to operator safety.**

With tinted safety glasses, transparent roof, sunblind, air-suspension seat, radio and plenty of storage spaces, the cab offers to the operators a **comfortable working environment.**

The **parallel wiper** assures the best cleaning of front windshield maximizing visibility also in the in poor weather conditions.

All switches and controls are ergonomically positioned on the right side, easy to find and to reach.



ETY & COMFORT

COMFORT SEAT

The comfortable **air-suspension seat** is a standard feature on VE models. It can be adjusted in all directions and back and forth, independently or together with side consoles.

The armrests can be inclined enabling the operator to set the correct position for maximum convenience and comfort.

TITLING CONSOLE

The left console is now **tilting**, enlarging the cab entrance for the operator and resulting **high comfortable** and **safely getting in/out** from the cab.

Steering column, with continuously adjustable inclination, allows to the operators the possibility to set **the correct and most comfortable position** both when driving on the road and working on job site.



LCD MONITOR

The monitor features a LCD screen by which the operator has **continuously control** of machine status.

Maintenance information is clearly displayed and the diagnostic function provides an early warning detection of any malfunctions.

Details of any previous breakdown or malfunction are also stored.

The standard **electronic immobilizer** (PIN code as on mobile phones) and the **attachments select function** are fast and easy to be activated and recalled by the menu.

WE210 EASY MAINTENANCE



SPACIOUS CAB

The simplified layout of all vital components of the New Holland WE210, under both the right and the left side panels, is designed to make inspections, maintenance and servicing **much easier with the better access providing high benefits** on operating costs and time

There is plenty of room in all compartments and most components are positioned in such a way to enable easy access from ground level. **An elegant and modern design added to state-of-the-art technology.**



Cooling components (radiator, hydraulic oil cooler and intercooler) are now mounted in parallel, which means increased cooling efficiency for higher component reliability whilst being easier to check and clean.

The engine oil filter and the fuel filter are remote mounted and easy to reach from ground level, through the right door inside the pump compartment.

The fuel filter, which removes contaminants, has an important function for engine performance and durability.



ANCE & SERVICEABILITY

SERVICE PLATFORM

The accessibility to the main valve as well to the engine compartment is provided by the **safe service platform** located behind the cab.

From this area it is possible to perform all service and maintenance operations: cleaning or change the air filter, the windshield water or the cooling expansion tank, access to the electronic components from the rear of the cab.

Easily and safely: this is the NewHolland target for maintenance and service.

The maintenance free batteries are located under service platform, easy to be connected if it is needed to start the engine with external assistance.

The **automatic master switch** is directly connected to the ignition key in the cab: extending the batteries life avoiding any loose of battery charge.



TOOL BOX

Inside the tool box, on front right corner, there is the optional fuel refilling pump which features an automatic stop function which makes simple to fill the tank.

FUSES

The fuses are inside the cab, protected from dust and water as well as easy to reach and control.



CENTRALISED GREASING

Maintenance procedures are also improved thanks to grouped and centralised greasing points, which allows all boom wear points to be easily greased from ground level. On request, the WE models can be equipped with an **“Automatic Centralised Greasing System”** to supply all wear points of the machine with the right quantity of grease at the right time. A winning tool to simultaneously reduce maintenance procedures and costs while improving machine reliability and durability.



WE210

SPECIFICATIONS



ENGINE STAGE IIIA

Net engine power (ISO 14396/ECE R120) 129 kW/173 hp
 Rated.....2000 rpm
 Make and model New Holland* 667TA/MEE
 Type..... diesel, 4-stroke direct injection, turbocharged and intercooler
 Displacement..... 6.7 l
 Number of cylinders6
 Bore/stroke 104 x 132 mm
Remote engine oil filter for easy replacement
Auto-Idling selector returns engine to minimum rpm when all controls are in neutral position
-25° C outside temperature start as standard equipment
 The engine complies with 97/68/EC standards Stage IIIA



ELECTRICAL SYSTEM

Voltage..... 24 V
 Batteries..... 2 x 12 V
 Battery rating (each)..... 100 Ah
 Alternator70 A
 Starter motor..... 4 kW



HYDRAULIC SYSTEM

Primary pumps..... 3 variable displacement, axial piston
 Total maximum flow490 l/min (2x195+110)
 Implement / travel pressure..... 340/345 bar.
 Power Boost.....370 bar.
 Swing circuit pressure.....390 bar.
 Pilot pump 45 bar.
 Boom cylinder mono 135 x 1050
 Boom cylinder 2-piece boom 135 x 985
 Arm cylinder..... 135 x 1400
 Bucket cylinder 115x1075
 Positioning cylinders..... 180 x 745

Control and monitoring system (Pump Control System IV).
 Electrohydraulic servo-control.
 Three-pump hydraulics with two main pumps and separate swing pump.
 Monitoring of engine and pumps by power limit control.
 7 selectable power stages for digging and lifting .
 Levelling mode for smooth operation.
 Automatic power increase in the drive mode.



SWING DRIVE

Swing speed 10 rpm
 Torque (SAE J1371)58 kNm

The swing function is operated by a hydraulic closed circuit coupled with a mechanical reducer integrating an automatic static brake.
 The hydrostatic swing brake is adjustable 3 settings.



TRANSMISSION

	STD	OPT
Max travel speed	20 km/h	30 km/h
Field travel speed	5 km/h	8 km/h
Min creep speed	2 km/h	2 km/h
Max drawbar pull.....		130 kN

Automatic or manual gear shifting control.
 Travel mode automatically engaged when pressing accelerator pedal
 Optional wider axles for higher stability when working unsupported; availability can be limited by local homologation



CAB AND CONTROLS

Sound absorbing cab in soft design.
 Tinted safety glass all around, push-in front window.
 Sunshade, roof window, transparent rain shield.
 LC display with integrated diagnosis function.
 Incline adjustable steering column.
 Ergonomic design of armrests and foot pedals, armrest is height adjustable.
 Operator's seat individually adjustable in height and inclination.
 Pre-installation for radio and loudspeaker.



BRAKE SYSTEM

Service brakes: oil bath disc type acting on all four wheels.
 Work brake: acts on service brakes and locks front axle oscillation.
 Parking brake: spring type mechanical acting on the transmission.
 Emergency brake: double braking circuit and automatic parking brake actuation with the engine shut down



STEERING

Type.....ORBITROL with safety valve
 Pump.....gear type
 Steering cylinderone, double effect
 Turning circle diameter (with 10.0 - 20 twin tires)..... 16,3



TYRES

Twin tyres..... 10.00 - 20 / 11.00 - 20
 Single tyres 600/40 - 22.5
 Tyre availability can be limited by local homologation



CAPACITIES

	Litres
Engine oil	16
Cooling system	30
Fuel tank	335
Hydraulic system	330

* Manufactured for New Holland by CNH UK Ltd

DIMENSIONS (mm)

Equipped with twin tyres 10.00-20

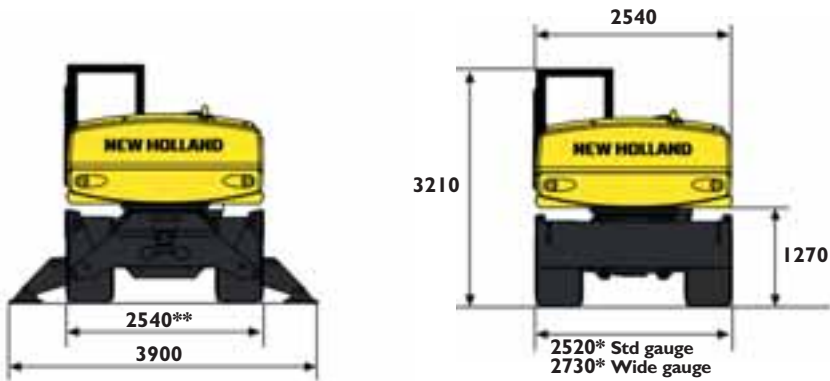

	STD GAUGE	WIDE GAUGE
*With twin tires 11.00 - 20	2540	2750
*With single tires 600/40 - 20	2490	2700
*With single tires 18R22.5	2500	2710
** Blade width	2530	2730

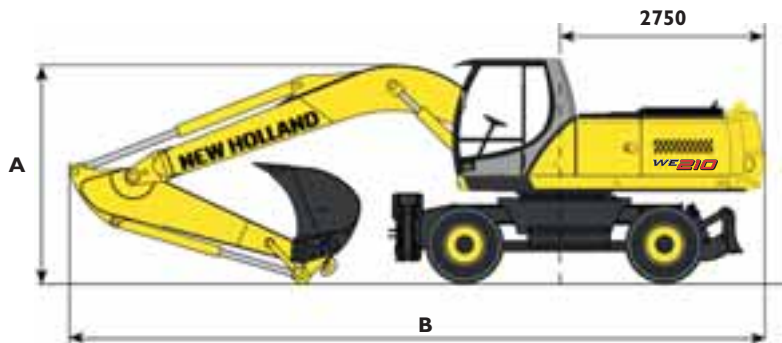

		TRIPLE ARTICULATION			MONOBOOM		
ARM		2300	2600	2900	2300	2600	2900
A	mm	3160	3160	3235	3225	3205	3285
B	mm	9435	9435	9405	9680	9680	9690

MAX OPERATING WEIGHTS (kg)

Including twin tires 10.00 - 20, bucket (650 kg)

EQUIPMENT TYPE	TRIPLE ARTICULATION	MONOBOOM
Rear Blade	20300	19800
Rear Blade & front stabilisers	21400	20900
Front & rear stabilisers	21900	21400

WE210

BREAKOUT FORCE*

ARM		2300	2600	2900
Bucket	kN	125,7	125,7	125,7
Dipperstick	kN	116,2	107,5	100,1

* For all boom version

DIGGING PERFORMANCE

		TRIPLE ARTICULATION		
ARM		2300	2600	2900
A - Max Digging Height	mm	10165	10240	10450
B - Max Dumping Height	mm	7245	7335	7550
C - Max Digging Depth	mm	5750	6030	6325
D - Digging Depth at Wall	mm	4300	4405	4680
E - Digging Depth at Flat Bottom	mm	5650	5930	6235
F - Max Reach	mm	9425	9650	9935
G - Max Reach at Ground	mm	9240	9470	9765
H - Minimum Turning Radius	mm	3200	3115	3195

		MONO BOOM		
ARM		2300	2600	2900
A - Max Digging Height	mm	10030	10040	10220
B - Max Dumping Height	mm	7145	7185	7365
C - Max Digging Depth	mm	5690	5990	6290
D - Digging Depth at Wall	mm	4475	4390	4665
E - Digging Depth at Flat Bottom	mm	5485	5800	6115
F - Max Reach	mm	9610	9815	10095
G - Max Reach at Ground	mm	9425	9640	9920
H - Minimum Turning Radius	mm	3285	3155	3205

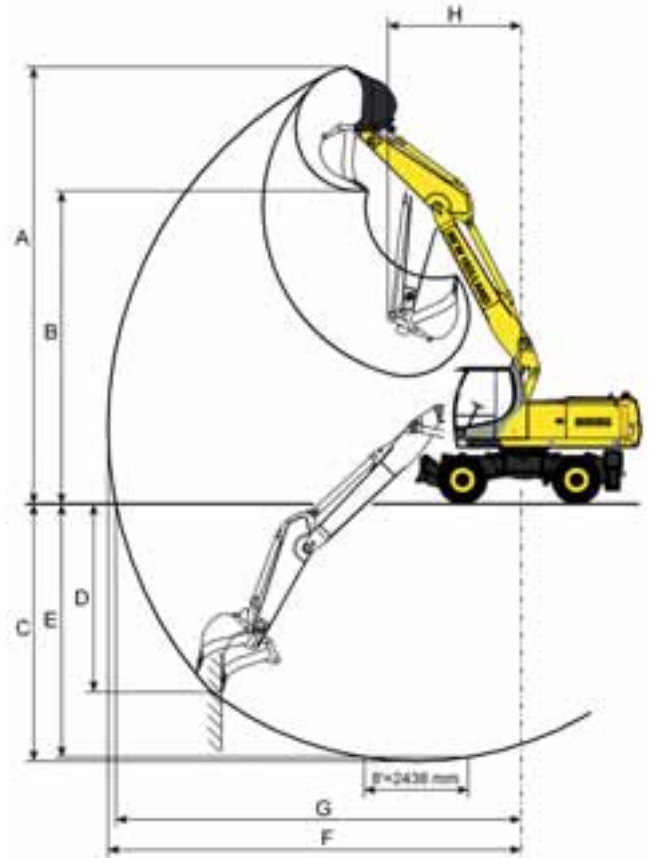

ATTACHMENTS

BUCKETS

Tested and approved, the selection of buckets assures high efficiency and productivity being the perfect completion of your WE excavator. Heavy duty version and skeleton type are also available for extreme excavation applications.

Width mm	Capacity ISO 7451 l	Weight kg	TRIPLE ARTICULATION									MONO BOOM								
			2300			2600			2900			2300			2600			2900		

GENERAL PURPOSE



750	525	505																	
850	625	535																	
1000	790	635																	
1200	1000	650																	
1300	1105	700																	
1500	1310	760																	

DITCH CLEANING

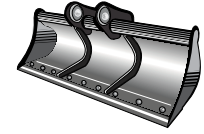

1800	735	540																	
2000	825	580																	
2200	910	620																	

TILT DITCH CLEANING

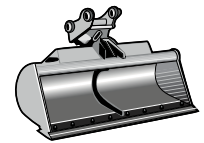

1800	735	1000																	
2000	825	1080																	
2200	910	1160																	

V - TYPE



500/2300	680	510																	
500/2900	750	650																	
500/3500	880	800																	

CLAMSHELL BUCKET WITH EXCHANGEABLE SHELLS

The C25VE clamshell bucket is ideal for different applications: excavation operations, landscaping, trench digging, handling of logs, thanks to the excellent closing forces up to 60 kN and the quick exchangeable shells technology, by which bucket carrier and bearings are integrated into the main body.

The continuous rotator with standard overload protection, with 3000 Nm of torque, and the vertical cylinders maximize the reliability, while the long life of cutting edges is ensured by the use of 500 HB steel.

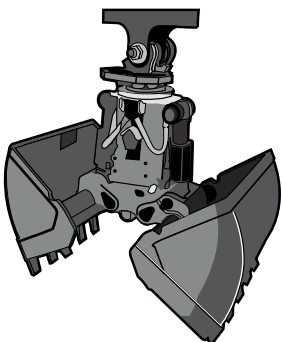

Width mm	Capacity ISO 7451 l	Weight kg	TRIPLE ARTICULATION									MONO BOOM								
			2300			2600			2900			2300			2600			2900		
425	210	915																		
500	250	950																		
600	305	985																		
800	410	1050																		
1000	520	1120																		
1200	625	1200																		

- General digging work (specific weight of material < 1.8 t/m³)
- Loading work (specific weight of material < 1.2 t/m³)
- Slightly heavy digging work (specific weight of material < 1.5 t/m³)
- Not recommended

ATTACHMENTS

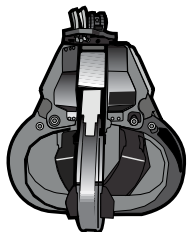

ORANGE PEEL GRABS

The P20V and P25V orange peel grabs are ideal for handling of bulky scrap in every application thanks to the choice of tine profiles: fully closing F, half closing H, wide style pointed W, pointed T.

Reliability is maximized thanks to: the continuous rotator with standard overload protection, the hydraulic cylinders with replaceable piston rod protection and cushioned end stroke system, the hydraulic hoses protected in the centre section.

The long life of tines is ensured by the high quality steel (400HB) and tips (500HB), which are replaceable.

Main Features are:

	P20V-450	P25V-550
Closed Width	1370 mm	1460 mm
Opened Width	1910 mm	2180 mm
Capacity	450 litres	550 litres
Torque	1500 Nm	1500 Nm

	TYPE PROFILE			
	F	H	W	T
P20V-450-4	1060	920	830	810
P20V-450-5	1145	1035	970	930
P25V-550-4	1320	1130	1025	1000
P25V-550-4	1460	1300	1225	1200



HAMMER

The New Holland Hammers are highly performing and reliable.

Silencing reduces noise and vibration and increases durability of the hammer and comfort for the operator.

	CB200S
Tool diameter	115 mm
Weight	1040 mm
Sound level	124 dBA

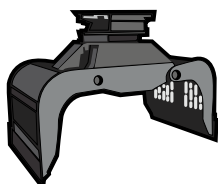

DEMOLITION AND SORTING GRAB

The D20H Demolition and Sorting grab -available also in the heavy duty (HD) version with reinforced box frame- and the Multi Purpose Grab A20H are available to maximize the versatility of WE models.

	D20H	D20H-HD	A20H
Width	1000 mm	450 litres	980 kg
Capacity	1000 mm	480 litres	1115 kg
Weight	700 mm	400 litres	950 kg

AT YOUR OWN DEALERSHIP

The information contained in this brochure is intended to be of general nature only. The NEW HOLLAND KOBELCO CONSTRUCTION MACHINERY S.p.A. company may at any time and from time to time, for technical or other necessary reasons, modify any of the details or specifications of the product described in this brochure. Illustrations do not necessarily show products in standard conditions. The dimensions, weights and capacities shown herein, as well as any conversion data used, are approximate only and are subject to variations within normal manufacturing techniques.

Published by NEW HOLLAND KOBELCO CONSTRUCTION MACHINERY S.p.A.
Printed in Italy - MediaCross Firenze - Cod 30633GB - Printed 05/11

Printed on recycled paper
CoC-FSC 000010 CQ Mixed sources



ELEMENTAL
CHLORINE
FREE
GUARANTEED



www.newholland.com

